



# AV Control System - UX Standard Style Guide



# System Overview

Diversified's UX Standard template provides an intuitive and efficient AV Control System user experience. Through collaboration between Design Engineers, Programmers and the UI/UX team, this interface has been carefully crafted for the seamless execution of presentation and conference related functions.

The diagram below draws attention to key navigation components:

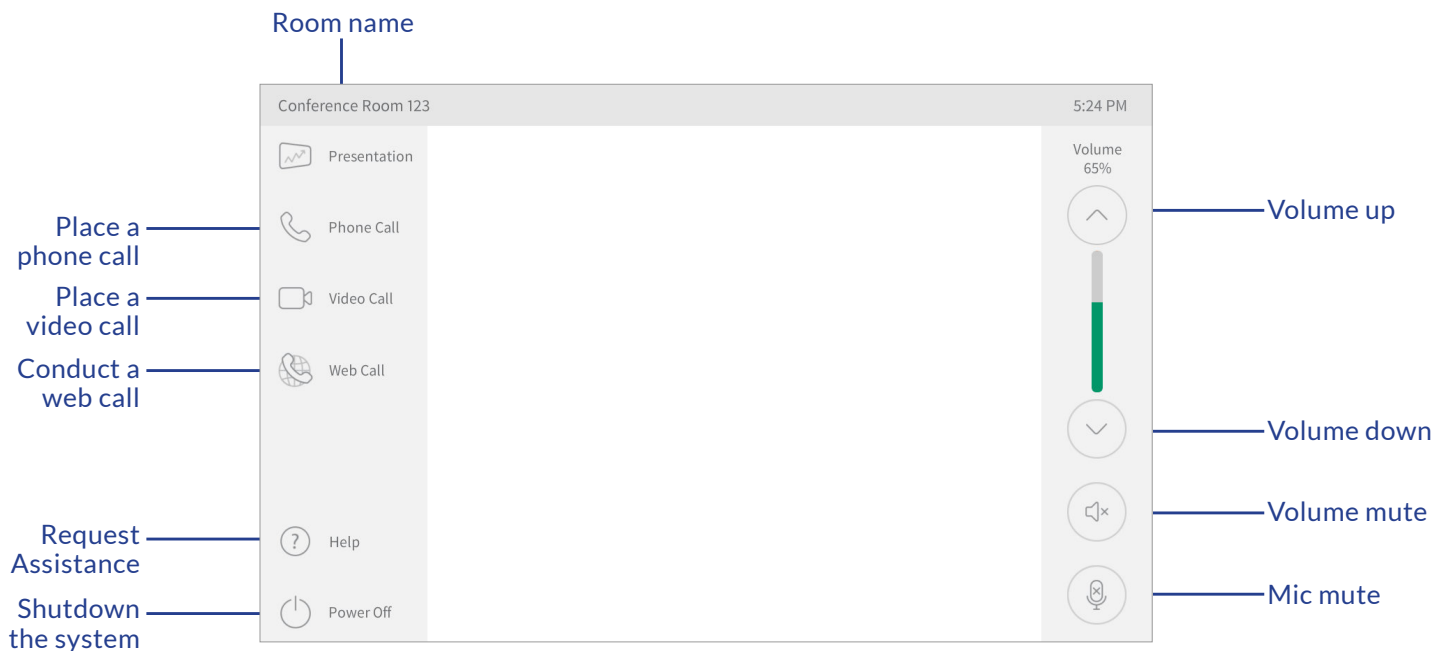

To maintain ease of use, it is critical to follow design and style guidelines when making any alterations or additions to the standard template. The following pages should be used as a set of design rules that ensure any modified interfaces will maintain a cohesive appearance and user experience in-line with the intentions of the base template.

The template uses a custom theme named **DIV\_Standard\_v00.01**. If you would like to request an addition or modification to the theme or touch panel file, please fill out the [AV Standard UI Addition Request](#) form.



# Layout

If functions need to be removed from the left menu, keep them aligned together and avoid any gaps.

Don't leave gaps when removing functionality (such as *Video Call*) from the left menu.

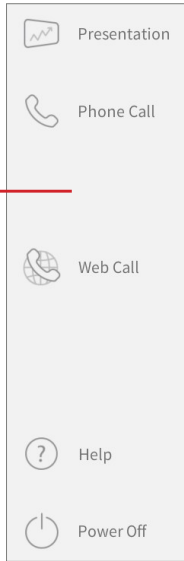

Do tighten up the list so they appear uniform in distance to each other

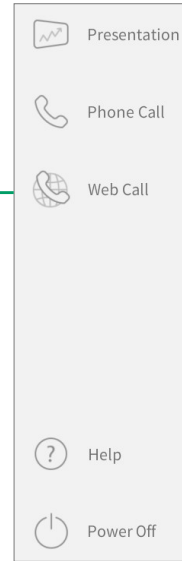

This rule does not apply to the space between *Help* and the last listed function. Treat room functions and *Help + Shutdown* buttons as two separate areas.

When adding pop-up pages, keep the layout of content consistent to existing pop-ups with similar controls.

Do not alter location of pop-up label text.

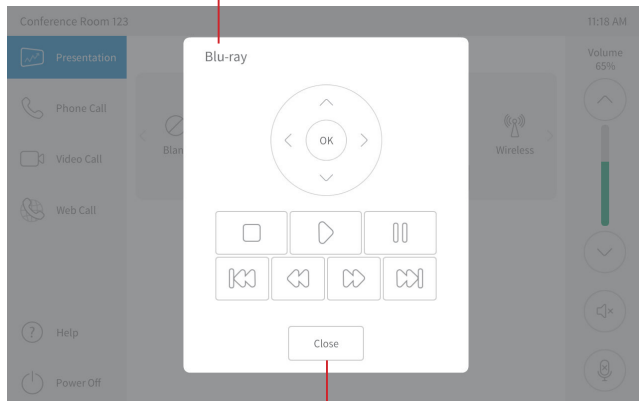

Do not alter location or appearance of common functions such as *Exiting a pop-up*.

Do place pop-up label text in the top center.

Do place a *Close* icon in the upper right corner of pop-up as a method of exit.

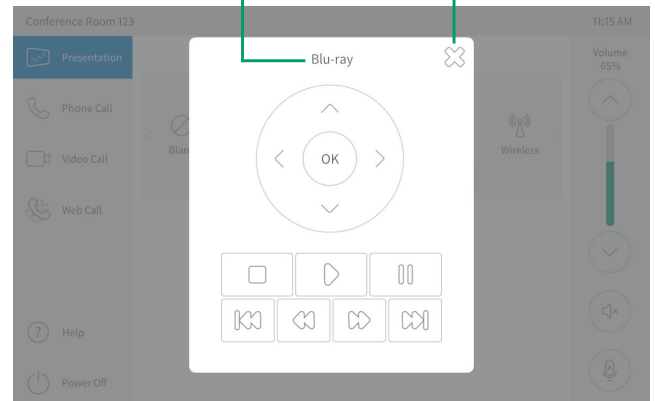



Above is a sampling of some of the icons used the Standard template. The icon set was created and styled using Adobe Illustrator software. The full icon set contains over 100 different icons. However, it may be possible that an icon is needed for a system that does not already exist in the theme file. In this scenario, you may fill out the [AV Standard UI Addition Request](#) form to request an icon addition. The following rules apply to any iconography that appears in the interface:



Size: 110 x 110 pixels  
Inactive RGB: 138:140:142 (gray)  
Active RGB: 255:255:255 (white)  
Stroke: 2 pts

Icons are to be stroke only, without any portions filled solid. Rounded corners are to be used and harsh 90 degree corners or intersections are to be avoided.



Don't use colored icons belonging to an entirely different aesthetic



Don't use a stroke of anything other than 2 pts.



Don't have portions of the icon with a solid fill.

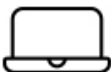

Don't use colors other than the specified icon RGB values.



# Buttons

The below buttons are approved styles for use in the User Interface. Except for in special cases, included below, button inactive states

### INACTIVE STATE

### PRESSED STATE

### ACTIVE STATE

**Left Menu Buttons**  
used for function selection *Help* and *Power*.



**Standard Buttons**  
used for the majority of device controls, as well as lists/directories.

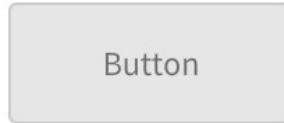
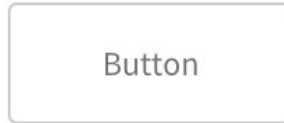

**Round Buttons**  
used for volume up/down, channel up/down, zoom in/out, etc...

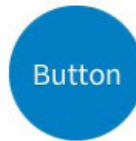

**Mute Buttons**  
used for toggling mute state. Red = muted.



**Dial/Hang Up Buttons**  
Press green buttons to call and red to end call.

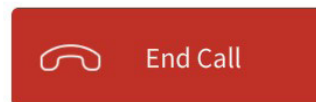
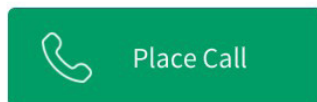

Green buttons are also reserved for special functions such as *Save*, *Search* and *Add Call*.

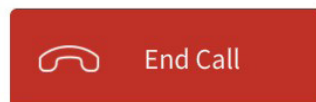



All fonts used throughout the Diversified Standard Template, belong to the Crestron Sans Pro (regular) family with the preferable size of 22pt.

The majority of the text used will be gray with a RGB value of **103:105:107**. Active states of buttons will use white text.

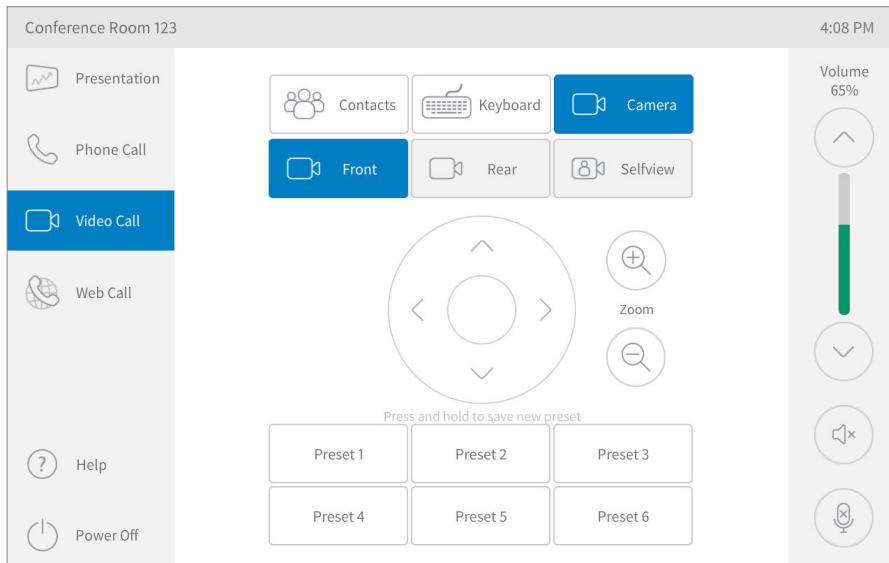

There will be the occasion when a lighter gray color (RGB = **192:192:192**) will be used for secondary information or clues for the user. An example of this usage is the *Press and hold to save new preset* text shown above.